



seed

APJ Abdul Kalam  
School of  
Environmental Design



community  
consciousness  
humanity

# Who We Are

SEED was established in the year 2018 under the aegis of APJ Abdul Kalam Charitable and Educational Trust. The members of this trust are a heterogeneous mix of architects, entrepreneurs and institution builders all sharing the same passion towards building a centre for excellence in the field of architecture and design.

**SEED** offers a 5-year Bachelor of Architecture course and is affiliated to Mahatma Gandhi University, Kottayam with a sanctioned intake per year of 80, approved by the Council of Architecture, New Delhi.

MOU with  
**CEPT**  
UNIVERSITY



Council of Architecture





nourishing  
empowering  
enriching

# Our Leadership



**Adv. T.S. Rasheed**  
Chairman  
APJ Abdul Kalam  
Charitable & Educational Trust.



**Ar. Sebastian Jose**  
Dean & Director  
MLA - SPA, Delhi  
Silpi Architects, Kochi



**Ar. Rajasekharan Menon**  
Academic Chair  
B.Arch - CEPT, Ahmedabad  
RGB Architecture Studio, Kochi



learn  
unlearn  
relearn

# Academic Council



**Dr. A. Srivathsan**  
Head of Academic Council  
Director, CEPT Research and  
Development Foundation



**Ar. Bijoy Ramachandran**  
Reviewer  
Founder and Partner  
Hundredhands, Bengaluru



**Ar. Biju Kuriakose**  
Reviewer  
Founder and Partner  
architectureRed, Chennai

# people of seed



**Ar. Balu Joseph**

Head of Faculty  
Associate Professor  
M.Arch - IIT Roorkee  
Oeuvre & Milieu, Kochi



**Ar. Kunjan Garg**

Foundation Studio Lead  
Assistant Professor  
B.Arch - CEPT, Ahmedabad  
RGB Architecture Studio,  
Kochi



**Ar. Jills Philip**

Second Year Studio Lead  
Assistant Professor  
B.Arch - MES, Kuttipuram  
SJA, Kochi



**Ar. Krishnan Varma**

Third Year Studio Lead  
Associate Professor  
M.Arch - ETH Zurich  
Meistervarma Architects,  
Kochi



**Ar. Reshma Mathew**

Fourth Year Studio Lead  
Associate Professor  
MSc - University of  
Edinburgh, UK  
Mado Design Studio, Kochi



**Ar. Abhishek Xavier**

Fifth Year Studio Lead  
Professor  
MA. MSc - Oxford Brookes  
University, UK



**Dr. Susan Cyriac**

Professor  
M.Plan - SPA, Delhi  
PhD - NIT, Calicut



**Ar. Abraham Panakal**

Associate Professor  
M.Arch - CEPT, Ahmedabad  
MDS Architects, Kochi



**Ar. Sherin S Varikkatt**

Associate Professor  
MAU - Archip, Prague  
Studio Tropical Being, Kochi



**Ar. Geslin R George**

Associate Professor  
M.Plan - Cornell University,  
USA



**Ar. Thomas Kariath**

Assistant Professor  
B.Arch - KRVA, Mumbai  
Urban Village Studio, Kochi.



**Ar. Chinchukumar S**

Assistant Professor  
B.Arch - SAP, Chennai  
Fictional Project, Kochi.



**Ar. Aparna Suresh**

Assistant Professor  
B.Arch - SRM University,  
Chennai  
Southern Studio, Kochi



**Ar. Nayantara H**

Assistant Professor  
M.BEM - SPA, Delhi



**Ar. Krishna Salim**

Assistant Professor  
M.Arch D - Oxford Brookes  
University, UK  
K-Associates, Tvm



**Ar. Aswathy Ganesh**

Assistant Professor  
B.Arch - CET, Trivandrum  
The One, Kochi



**Ar. Anjali Sreekumar**

Assistant Professor  
MAHR - CEPT, Ahmedabad



**Ar. Fayiz Muhammed.M**

Wellness Coach and  
Student mentor  
B.Arch - Anna University, Chennai  
Local Hands Project, Kochi



**Er. Remya Augustine**

Assistant Professor  
M.Tech - VNIT, Nagpur



**Er. Reenu Saju**

Assistant Professor  
M.Tech - CEPT, Ahmedabad



**Ar. Lakshmi Prabha E**

Assistant Professor  
MS by Research - IIT  
Madras



**Ar. Roshni Kannan**

Assistant Professor  
M.AHT - CEPT, Ahmedabad



**Ar. Chitra V.**

Assistant Professor  
B.Arch - TKM, Kollam  
MSc. Psychology  
The Design Pursuit, Kochi



**Md Samim Alam Beg**

Assistant Professor  
MFA - Rabindra Bharati  
University, Kolkata



**PEOPLE OF SEED @  
The Seed Academic Conclave  
January 11-12, 2025  
at Whispering waters Resort, Paniye**



**SEED GALLERY**

At the end of every semester, selected works from across studios are showcased in the SEED Exhibition Gallery. This platform brings together the best of student explorations, allowing peers to engage with each other's work, exchange ideas, and initiate meaningful dialogues across different verticals.



**Ar. Anakha J Anupam**

Assistant Professor  
M.Plan - SPA, New Delhi



**Ar. Farhaan Mohammed**

Assistant Professor  
B.Arch - CET, Trivandrum  
Integral de(x), Kochi



**Ar. Litty Salas**

Assistant Professor  
MA Design - Design Academy  
Eindhoven, The Netherlands



**Ar. Blessy John**

Assistant Professor  
B.Arch - B.V. Bhoomaraddi  
College of Engineering, Hubli  
Urban Village Studio, Kochi



**Ar. Sanand Karunakaran**

Assistant Professor  
M.Arch - SPA, New Delhi  
Sagar Sanand Architects, Kochi

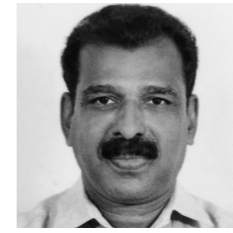

**Mr. Baby Sacaria**

Visiting Faculty  
Mathematics  
MSc, BEd & SET



**Mr. Biju George**

Registrar  
MSc, BEd & SET  
Newman College  
MG University



**Mr. Ajith Gangadharan**

Head of Administration  
LLB, VVLC  
Mysore University



**Ms. Sreedevi K R**

Chief of Accounts  
M.Com Finance



**Mr. Joe Joseph**

Librarian  
MA, MLIS, MPhil



# Bachelor of Architecture

## UNDERGRADUATE PROGRAM

**Seed's five-year** undergraduate program in Architecture aims to place high emphasis on self-realization and individual centric learning to develop a community of committed and value based professionals. As a design school, **Seed** is committed towards creating an organic space of passion, application and bonhomie while negotiating divergences among individuals and thought processes to build a centre for excellence in all avenues of environmental design. The school firmly believes that it is important for the student to be able to look through multiple perspectives to adopt the most appropriate, ethical and context sensitive design stance.

Therefore, the learning is multidisciplinary and student centric, and offers them exposure to significant thought leaders from multiple fields. The seed program is designed with focus on the emerging dynamics of the industry and the rapidly transforming image of the architect in the contemporary technological society.

# Our Studio Programs

The Seed B Arch course is structured in two stages:

## STAGE 1 - Building Core Competencies

The first 3 academic years / 6 semesters (of approximately 16 working weeks each of the course) shall be a basic standard course

### Sem 1-2. Foundation Studio:

Exploration of ways of seeing, understanding and interpreting objects, places and events, learning to look beyond the obvious, into the unseen and often absurd qualities of things.

Understand and employ the conventions of architectural drawing systems, including plans, sections, elevations, diagrams, three-dimensional representations, renderings and animations.

### Sem 4. Land Building Studio:

Learning to refine architecture and its interaction with landscape through consideration of spatial organisation, environmental context and structural necessity. Landscape is seen as a part of the larger continuum.

### Sem 6. Material Detailing Studio:

Bridging the gap between academics and construction practices. Development in architectural design through the exploration of materials, structures, construction, and environmental modification that is integrated with programmatic detail within a building design.

### Sem 3. Space Making Studio:

Investigation into the fundamental principles of making of buildings, including structure, enclosure, circulation and program. The ability to draw inspiration from a broad body of knowledge. Incorporation of abstract thinking and abstraction within architectural production.

### Sem 5. Climate Responsive Studio:

The studio intends to develop climate consciousness through purely analog methods such that design intuition about elements of nature is safeguarded. The studio then moves through rigorous testing methods in the climate lab following which they are fine-tuned, and its climate responsiveness quantitatively analyzed through digital techniques.

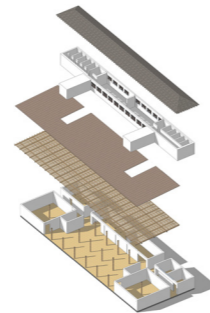
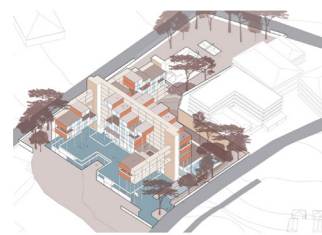
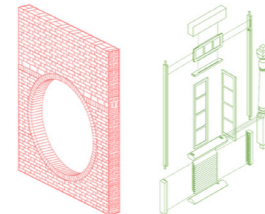
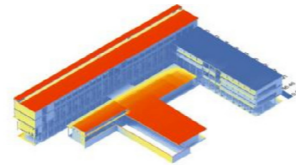
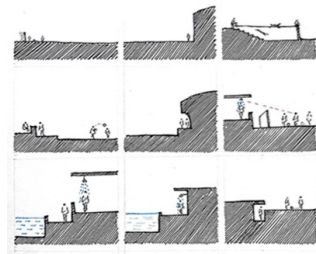
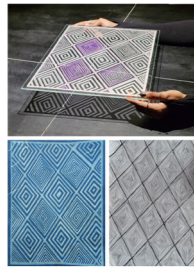



# Our Studio Programs

The seed B Arch course is conducted in two stages:

## STAGE 2 - Specialization

The second stage of the course shall be of 2 academic years / 4 semesters (of approximately 16 working weeks each) including an internship semester

### Sem 7. Housing Studio:

This studio mainly focuses on reading architecture with the larger context and various social concerns through the aspect of housing. The studio addresses the role of housing in determining urban transformations in the city, and architecture as a means of improving the urban living environment on a community and an individual level.

### Sem 8. Internship:

Offers orientation under a practicing architect, which includes preparation of conceptual design, presentations, client meetings, working drawings, tendering process, site supervision and execution. Negotiation is a crucial part of the design profession, and internships offer the student a glimpse into the existing reality of design practice, making them better equipped to tackle the upcoming design studios and practice as a career.

### Sem 9. Urbanism:

Familiarising the students with urban design vocabulary. Exposing them to complexities of architectural interventions in urban settings, which include anthropological and sociological aspects, the built-unbuilt relations, urban guidelines and regulations, and contextual concerns such as that of climate and building materials.

### Sem 10. Thesis:

The Graduation Project is central to the School's pedagogy and a lot of care is given to the way this is structured. Each preceding semester is seen as a stepping stone towards this final flourish. Students are encouraged to conceive innovative projects across a wide spectrum of thoughts and ideas. Experienced and accomplished faculty with versatile design approaches are assigned the responsibility of guiding the students. This opens up possibilities of exchanges of ideas between mentees.

## TENSILE STRUCTURE

As a part of foundation year Seediagonals, students had the opportunity to explore structural systems and gain hands-on experience by constructing them on campus.

# seed study trips

Singapore - Vietnam - Malaysia - Srilanks - Hampi- Badami - Bangalore - Bhuj - Hyderabad - Chennai

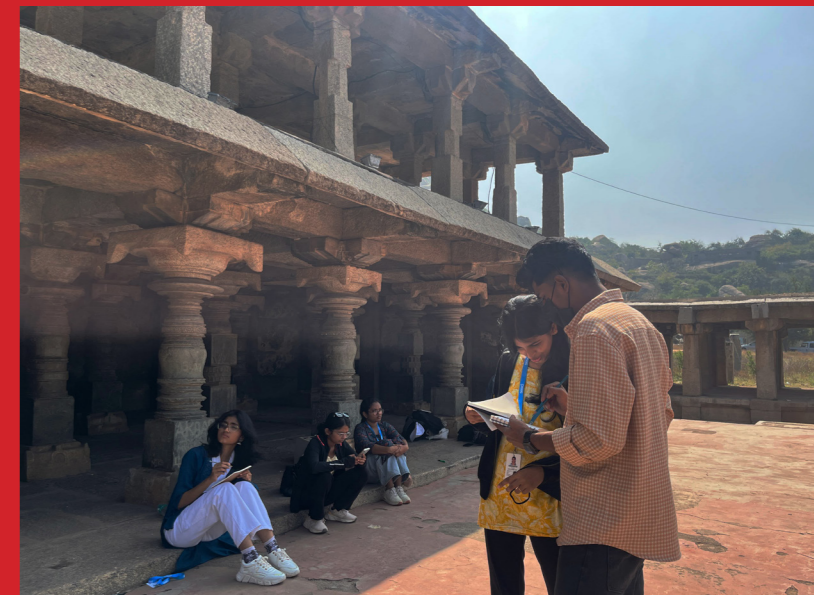
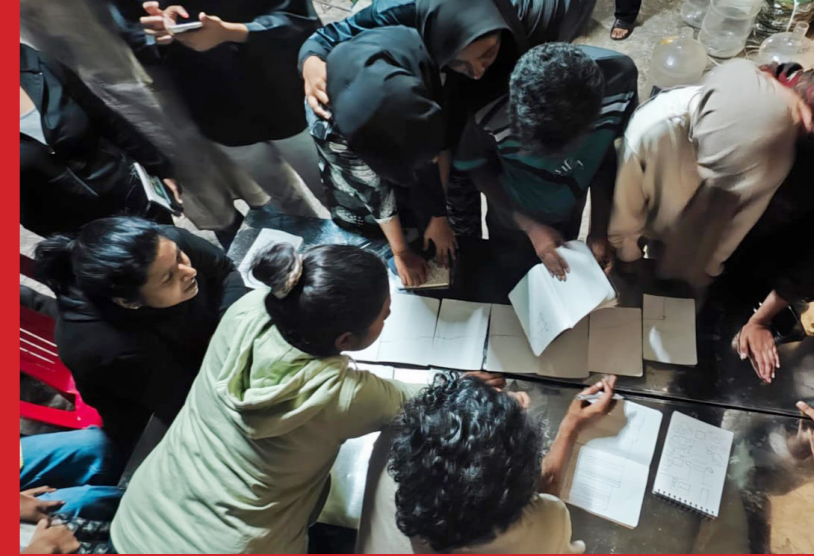

## Sem 1&2. Foundation Studio - Hampi & Badami

As part of the Foundation Studio curriculum, a Related Study Programme (RSP) is conducted at the beginning of Semester 2. This programme focuses on fieldwork that involves understanding the existing context and architecture, and documenting it through the technique of measured drawings. Students are taught to observe their surroundings closely, analyze architectural details, and apply anthropometric principles to grasp the scale and proportions of structures. The process of measurement and documentation enhances their understanding of architectural space and design. The study typically lasts between 7 to 14 days. In January 2025, first-year students traveled to Hampi, Karnataka where they studied ancient structures, and visited the settlements in Badami, Karnataka.



**Sem 9. Urban Design Studio - Vietnam**

As part of the studio curriculum, a study trip to Vietnam was conducted from 1<sup>st</sup> to 8<sup>th</sup> November 2024. Here, students observed active water edges in the rural setting of Cai Be, peri-urban Can Tho, and urban Ho Chi Minh City. The trip included guided tours of housing projects by anthropologist Mr. Heiu from Architecture Excursions. Ar. Marco Buinhas, EnCity and Dr. Vu Viet Anh, University of Architecture Ho Chi Minh City's Department of Planning Architecture also delivered lectures as part of this trip.

**Sem 7. Housing Studio - Singapore**

The studio questions how housing can evolve to absorb both the individual and collective needs of urban living, while simultaneously creating a framework for the community at the micro and macro levels. With this intention, a curated study trip was organised to Singapore from 25<sup>th</sup> to 29<sup>th</sup> October, 2024. The objective was to learn about exemplary building practices that focus on a high rise, high density, sustainable method of construction, where a definitive gesture is made towards creating demographic and pedestrian friendly public spaces within the city.

spirit

of

seed

zeitgeist

/zAitgAist/

seødtrack

seødscape

seødiagonals

seødgeist

seødialogues

seødbaazar

seødtalks

**Seedgeist** is the annual festival of Seed, an amalgamation of all our flagship programs. Exhibitions, workshops, guest lectures, publications and products are all designed and developed by students of Seed.



## seedscape:

Seedscape is the annual exhibition showcasing the exceptional work of Seed community. All the past five editions of Seedscape were well attended, and have consistently featured some of the most important architects from the contemporary Indian Architectural scene, making it a highly anticipated event. Opening its doors to the general public, the exhibition underscores Seed's commitment to engaging with a wider audience, viewing this interaction as pivotal for the school's continued growth and development.







seed APJ Abdul Kalam School of Environmental design

Livingetc

tomorrow is now 2024

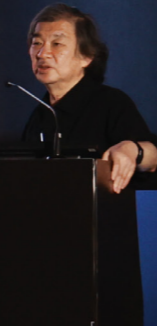

tomorrow is now 2024



tomorrow is now 2024

The first of the “Tomorrow is Now” talk series was conducted on June 24, 2024, at the Le Meridian Hotel, Kochi. We kicked off the event with a lecture by the eminent 2014 Pritzker Laureate, Ar. Shigeru Ban. The event was a huge success, with over 1,000 attendees. Ar. Ban’s intriguing presentation took us through his projects, showcasing innovative construction techniques and sustainable solutions. It was truly insightful to learn from the man himself. At Seed, we aim to continue this lecture series, bringing the best minds to this part of the world. We believe it is our duty as an institution to give back to the society.

A wide-angle photograph of a large audience seated in a theater. The seats are red, and the audience is densely packed, filling the frame from the foreground to the back. The theater has a modern design with wood-paneled walls and a curved ceiling. The lighting is warm and focused on the audience. In the bottom left corner, there is a large white text overlay with a red plus sign.

**1000+**  
**attendees**



## seediagonals:

Seediagonals is a semester break school hosted by Seed. It offers additional certification courses for students and young graduates of architecture to improve their skill sets and expand their knowledge of multiple aspects of architecture, design and allied subjects.

## seedialogues:

Seedialogues launched in 2020 as a platform with a vision to connect with a spectrum of stakeholders, and engage in lively debates and critical discourse on issues in architectural theory and practice. Seedialogues seeks to inspire transformative thinking, and shape future architectural discourse in a collective and inclusive manner.

## seedtrack:

The Inter-College Sports Meet, SeedTrack, is a highly anticipated event that showcases the skills and talents of young athletes while promoting healthy competition and teamwork. From athletics to football, throw-ball, volleyball, cricket there is something for everyone in this exciting sports event.

## seedtalks

SeedTalks is a captivating series of discussions led by experts across disciplines of architecture, art, and design. These enriching dialogues help participants gain a deeper understanding of the interconnected nature of these disciplines, fostering a dynamic exchange of ideas and innovation.



# Campus Facilities

- Well designed campus nestled in a verdant landscape, with state-of-the-art studios
- Versatile faculty team with the right mix of practicing architects, experienced academicians and researchers
- Multiple workshop opportunities for immersive hands-on experience
- Well-equipped library and computer lab
- Fully residential campus that is open 24x7
- Ragging-free campus with a dedicated sports coach
- Well-appointed cafeteria and residential mess facility
- Fully operational exhibition gallery dedicated for student works
- Vibrant campus life bustling with activities led by Students' Council

# Admission 2026

seed

Discover your true potential in architecture at **seed**. Our B. Arch program is designed to nurture creativity, impart technical expertise and a deep understanding of architectural principles. Join a community of aspiring architects guided by experienced faculty, and unleash your potential in a state-of-the-art learning environment. Seize the opportunity to shape the future of design. Apply for B. Arch admission 2026 at Seed today!

Total seats : 80

Total seats under management / NRI category : 40

Total seats under merit : 40

College code : APR

#### **Criteria for admissions under management and NRI category :**

All candidates who have:

- 1) Passed in 12<sup>th</sup> Class with PCM Subjects/ 10+3 Diploma with Mathematics.\*
- 2) Qualified NATA – The National Aptitude Test in Architecture conducted by the Council of Architecture.\*\*
- 3) Completed 17 years of age as of the last date of submission of the Application form.

Both of the above shall carry 50% weightage in the matter of admissions. However, admission to management seat shall be strictly on merit and based on the student's performance in the Seed Entrant Evaluation [SEE] process.



PROSPECTUS B.ARCH ADMISSION 2026-27  
SEED - APJ Abdul Kalam School of Environmental Design

## APPLY NOW

[www.seed.edu.in](http://www.seed.edu.in)

[info@seed.edu.in](mailto:info@seed.edu.in)

+ 91 98 465 048 88

### Location

APJ Abdul Kalam School of Environmental Design,  
Mekkadambu P.O, Kadathy,  
Muvattupuzha, Ernakulam,  
Kerala, 682316.

### General administration

For Enquiry : +91 98 465 048 88 / +91 97 442 311 99

Chairman : +91 94 001 888 88

### Visiting Hours

Monday to Saturday 9:00 AM to 4:30 PM

## CREDITS

### Concept and Design

Ar Krishna Salim

### Photo credits

Francis J Emmanuel

Ar Balu Joseph

Seed Social



explore  
express  
experiment

**choose an apprenticeship in  
design studios led by the  
best professionals**



**seed** APJ Abdul Kalam  
School of  
Environmental Design